

QUARTZSYSTEM - Consumables - NW®/SPARTUS® - 9/20

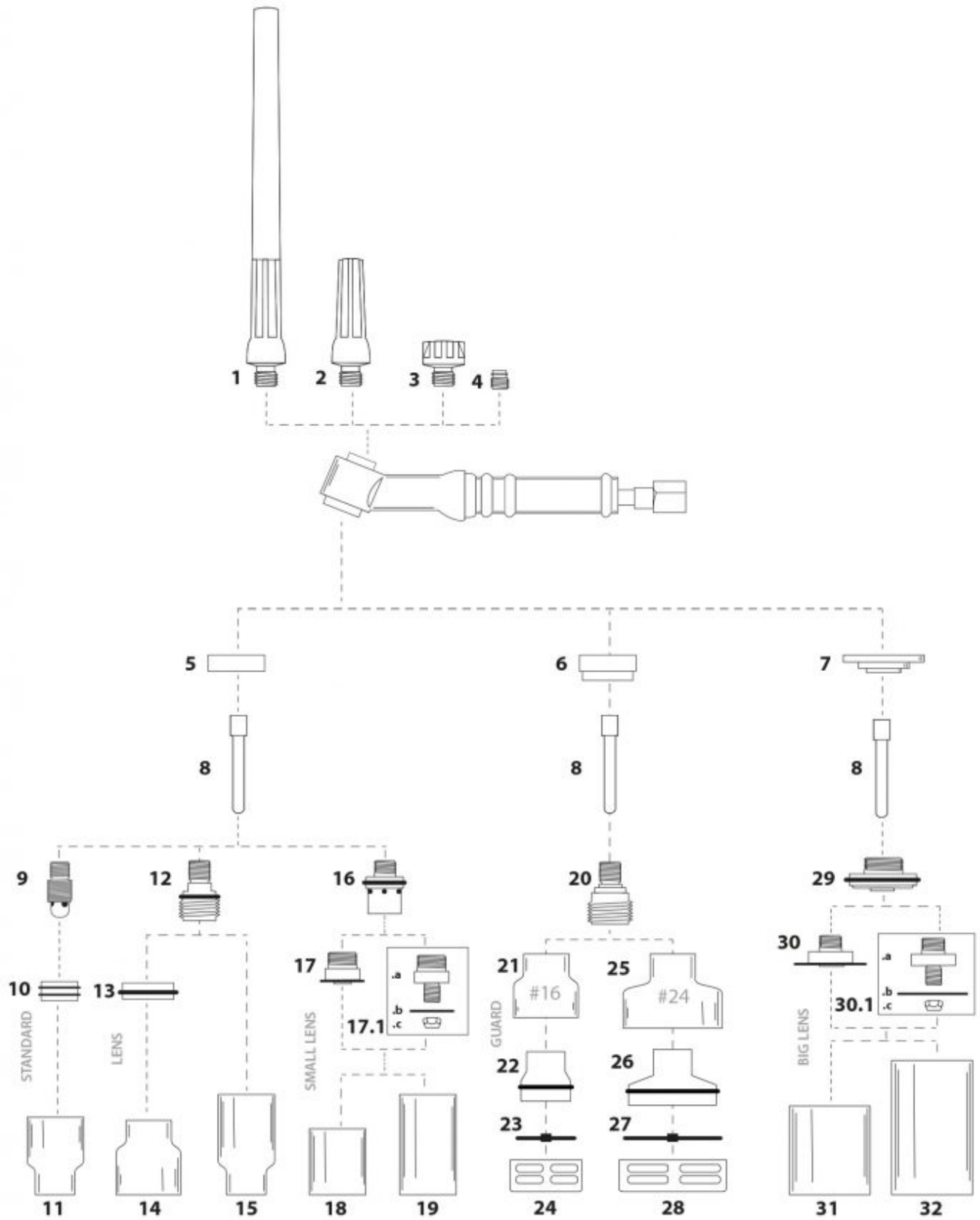

| Lp. | Product code | Product name | Electrode diameter [mm] | Net price |
|-------|--------------|---|-------------------------|-----------|
| 1 | NW41V24 | Long back cap 9/20 | | 0.41 € |
| 2 | NW41V35 | Medium back cap 9/20 | | 0.26 € |
| 3 | NW41V33 | Short back cap 9/20 | | 0.24 € |
| 4 | NW41V21 | Micro back cap 9/20 | | 1.88 € |
| 5 | NW9-25N10 | Gas insulator QUARTZSystem 9/20 standard / lens | | 0.39 € |
| 6 | NW598882 | Gas insulator 9/20 (teflon) | | 0.12 € |
| 7 | NW9-33N29 | Gas insulator QUARTZSystem 9/20 big lens | | 1.49 € |
| 8 | NW9-25T16 | Collet QUARTZSystem 9/20 standard / lens L=25.5mm d=1.6mm | 1.6 | 0.39 € |
| | NW9-25T24 | Collet QUARTZSystem 9/20 standard / lens L=25.5mm d=2.4mm | 2.4 | 0.39 € |
| 9 | NW13N27 | Collet body 9/20 [d=1.6mm] | 1.6 | 0.27 € |
| | NW13N28 | Collet body [for torch 9/20] - L=21mm d=2.4mm | 2.4 | 0.27 € |
| 10 | NW9-25A10 | Adaptor 9/20 QUARTZSystem standard L=8mm d=13.6mm | | 0.79 € |
| 11 | NW9-17-25D10 | Gas nozzle L=25mm d=14/10mm QUARTZSystem standard, 17/18/26 standard short ver. | | 3.79 € |
| 12 | NW9-33S16 | Gas lens collet QUARTZSystem 9/20 - L=25.5mm d=1.6mm | 1.6 | 2.16 € |
| | NW9-33S24 | Gas lens collet QUARTZSystem 9/20 - L=25.5mm d=2.4mm | 2.4 | 2.16 € |
| 13 | NW9-17-28A16 | Adaptor QUARTZSystem 9/20 17/18/26 D=19.4mm L=7mm d=1,6mm | | 3.93 € |
| | NW9-17-28A24 | Adaptor QUARTZSystem 9/20 17/18/26 D=19.4mm L=7mm d=2,4mm | | 3.93 € |
| 14 | NW9-17-28D21 | Gas nozzle flaring d=21mm L=28mm QUARTZSystem 9/20 17/18/26 lens | | 3.93 € |
| 15 | NW9-17-33D10 | Gas nozzle d=10mm L=33mm QUARTZSystem 9/20 lens; 17/18/26 lens shot ver. | | 3.93 € |
| 16 | NW9-25A20 | Adaptor QUARTZSystem 9/20 small lens L=20,6mm d=8,5mm | | 1.18 € |
| 17 | NW9-17-25S16 | Small gas lens collet QUARTZSystem 9/20 17/18/26 L=12.5mm d=1.6mm | 1.6 | 2.08 € |
| | NW9-17-25S24 | Small gas lens collet QUARTZSystem 9/20 17/18/26 L=12.5mm d=2.4mm | 2.4 | 2.08 € |
| 17.1 | NW9-17-26S16 | Small gas lens collet set with replaceable strainer QUARTZSystem 9/20 17/18/26 L=16mm d=1.6mm | 1.6 | 2.40 € |
| | NW9-17-26S24 | Small gas lens collet set with replaceable strainer QUARTZSystem 9/20 17/18/26 L=16mm d=2.4mm | 2.4 | 2.40 € |
| 17.1a | NW9-17-26A16 | Small gas lens collet body QUARTZSystem 9/20 17/18/26 L=16mm d=1.6mm | 1.6 | 1.27 € |
| | NW9-17-26A24 | Small gas lens collet body QUARTZSystem 9/20 17/18/26 L=16mm d=2.4mm | 2.4 | 1.27 € |
| 17.1b | NW9-17-26P20 | Strainer QUARTZSystem 9/20 17/18/26 small lens | | 0.77 € |
| 17.1c | NW9-17-26J20 | Nut QUARTZSystem 9/20 17/18/26 small lens | | 0.39 € |
| 18 | NW9-25D20 | Gas nozzle d=14mm L=25mm QUARTZSystem 9/20 small lens | | 2.33 € |
| 19 | NW9-17-32D20 | Gas nozzle d=14mm L=32.5mm QUARTZSystem 9/20 17/18/26 small lens | | 2.83 € |
| 20 | NW45V43 | Gas lens collet body 9/20/24/24W [d=1.6mm] | 1.6 | 1.51 € |
| | NW45V44 | Gas lens collet body 9/20/24/24W [d=2.4mm] | 2.4 | 1.51 € |
| 21 | NW9-17-32D32 | Gas nozzle QUARTZSystem GUARD #16 - L=28mm d=32mm | | 10.27 € |
| 22 | NW9-17-32A32 | Brass adaptor QUARTZSystem GUARD #16 L=24mm d=21mm | | 3.40 € |
| | NW9-17-32R32 | O-ring QUARTZSystem GUARD #16 | | 1.00 € |
| 23 | NW9-17-32S16 | Strainer QUARTZSystem GUARD lens 9/20, short ver. 17/18/26 d=1.6mm | | 3.40 € |
| | NW9-17-32S24 | Strainer QUARTZSystem GUARD lens 9/20, short ver. 17/18/26 d=2.4mm | | 3.40 € |
| 24 | NW9-17-32P32 | Protective ring QUARTZSystem GUARD #16 | | 3.40 € |
| 25 | NW9-17-38D44 | Gas nozzle QUARTZSystem GUARD #24 L=40mm d=38mm | | 13.70 € |
| 26 | NW9-17-38A44 | Brass adaptor QUARTZSystem GUARD #24 L=36mm d=28mm | | 5.12 € |
| | NW9-17-38R44 | O-ring QUARTZSystem GUARD #24 | | 1.29 € |

| Lp. | Product code | Product name | Electrode diameter [mm] | Net price |
|-------|--------------|---|-------------------------|-----------|
| 27 | NW9-17-38S16 | Strainer QUARTZSystem GUARD lens 9/20, short ver. 17/18/26 d=1.6mm | | 5.12 € |
| | NW9-17-38S24 | Strainer QUARTZSystem GUARD lens 9/20, short ver. 17/18/26 d=2.4mm | | 5.12 € |
| 28 | NW9-17-38P44 | Protective ring QUARTZSystem GUARD #24 | | 3.40 € |
| 29 | NW9-33A29 | Adaptor QUARTZSystem 9/20 big lens | | 4.99 € |
| 30 | NW9-17-33S16 | Big gas lens collet QUARTZSystem 9/20 17/18/26 L=12mm d=1.6mm | 1.6 | 3.93 € |
| | NW9-17-33S24 | Big gas lens collet QUARTZSystem 9/20 17/18/26 L=12mm d=2.4mm | 2.4 | 3.93 € |
| 30.1 | NW9-17-34S16 | Big gas lens collet set with replaceable strainer QUARTZSystem 9/20 17/18/26 L=18mm d=1.6mm | 1.6 | 4.39 € |
| | NW9-17-34S24 | Big gas lens collet set with replaceable strainer QUARTZSystem 9/20 17/18/26 L=18mm d=2.4mm | 2.4 | 4.39 € |
| 30.1a | NW9-17-34A16 | Big gas lens collet body QUARTZSystem 9/20 17/18/26 L=16mm d=1.6mm | 1.6 | 1.27 € |
| | NW9-17-34A24 | Big gas lens collet body QUARTZSystem 9/20 17/18/26 L=16mm d=2.4mm | 2.4 | 1.27 € |
| 30.1b | NW9-17-34P29 | Strainer QUARTZSystem 9/20 17/18/26 big lens | | 1.30 € |
| 30.1c | NW9-17-34J29 | Nut QUARTZSystem 9/20 17/18/26 big lens | | 0.39 € |
| 31 | NW9-17-33D29 | Gas nozzle d=29mm L=33mm QUARTZSystem 9/20 17/18/26 big lens | | 7.82 € |
| 32 | NW9-17-47D29 | Gas nozzle d=29mm L=47mm QUARTZSystem 9/20 17/18/26 big lens | | 7.82 € |

NW ® is independent subject and not connected to ABITIG®, AMPHENOL®, ASPA®, BESTER®, BINZEL®, CEA®, CEBORA®, ESAB®, EWM®, FALTIG®, FRO®, FRONIUS®, HARRIS®, HYPER THERM®, KJELLBERG®, L-TEC®, LINCOLN®, MAGNUM®, OTC®, SAF®, SHERMAN®, TELWIN®, THERMAL DYNAMICS®, TRAFIMET®, TUCHEL®.

Reference numbers and names belonged to above companies were called due to Property Right Law for buyer's convenience and they are related to code and spare part's description.

The products do not constitute an offer within the meaning of the Civil Code.