

PLAZMA - Consumables - UNITORCH™ - EL120H / EL120M

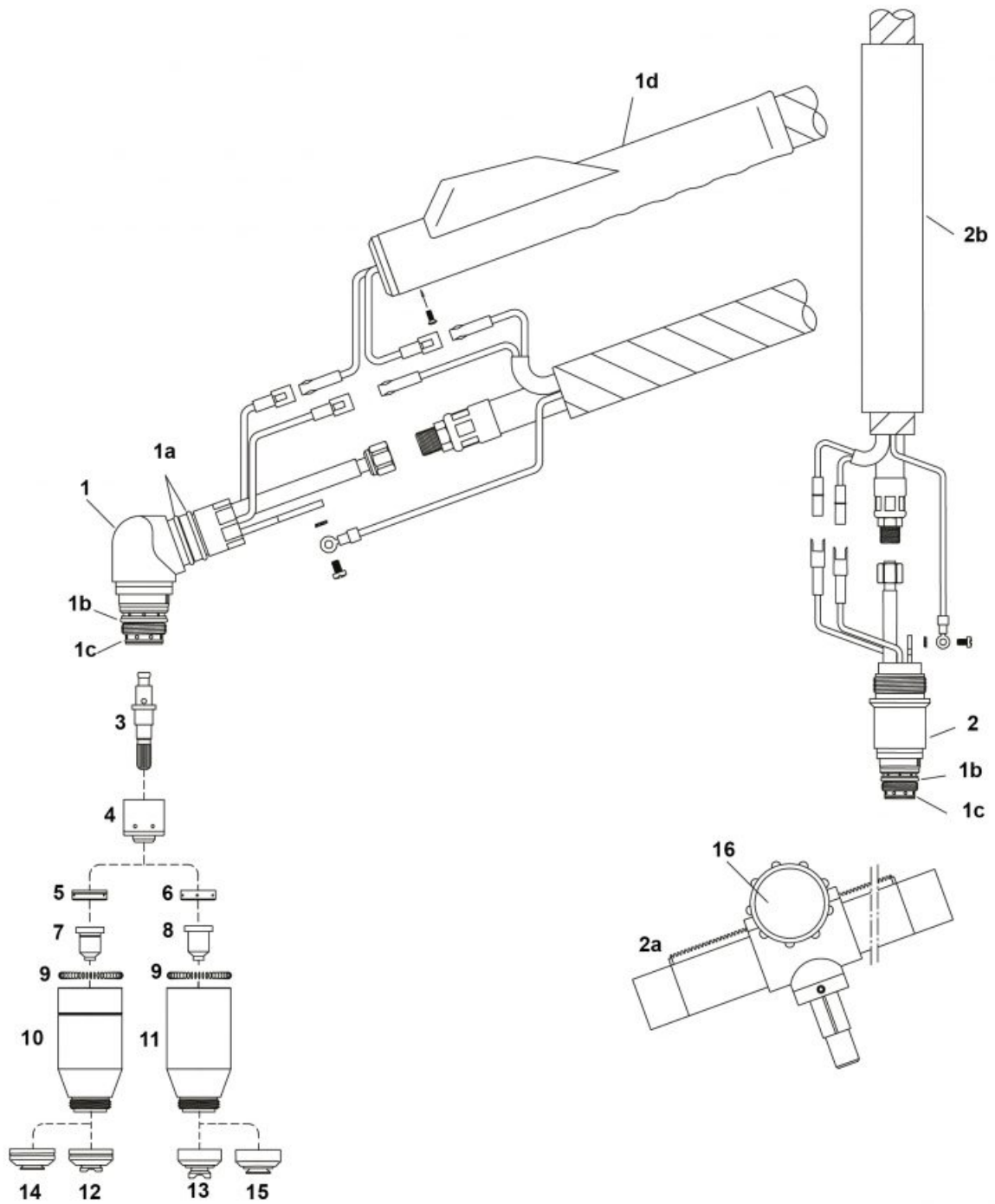

Lp.	Product code	[H]	[M]	Product name	Net price
1	07920	:	:	Torch head	209.76 €
1a	07100.53	■		O-ring	1.05 €
1b	NW07300.60	■	■	O-ring	1.05 €
1c	07920.60	:	:	O-ring	1.05 €
1d	07106E	:	:	Handle with microswitch	26.57 €
2	07921	:	:	Machine torch head	234.80 €
2a	07216	:	:	Positioning tube with rack	131.00 €
2b	07215		■	Machine handle	52.13 €

Lp.	Product code	[H]	[M]	Product name	Net price
3	NW52600	:	:	Electrode, Air/N2	4.32 €
4	07923	:	:	Start cartridge 30-120A (without HF)	27.81 €
5	60060	:	:	Gas distributor 30-60A	8.88 €
6	60061	:	:	Gas distributor 60-120A	9.53 €
7	51470	:	:	Tip cutting 30A	2.26 €
	51471	:	:	Tip cutting 40A	2.26 €
	51472	:	:	Tip cutting 50-60A	2.26 €
8	51474	:	:	Tip cutting 60A	2.26 €
	51475	:	:	Tip cutting 70A	2.26 €
	51476	:	:	Tip cutting 80A	2.26 €
	51477	:	:	Tip cutting 90-100A	2.26 €
	51478	:	:	Tip cutting 120A	2.26 €
9	60442	■	■	Coil spring	1.37 €
10	60480	:	:	Shield cap 30-60A	15.79 €
	60480/S	■	■	Shield cap 30-60A Max Life	22.71 €
11	60481	:	:	Shield cap 60-120A	15.55 €
	60481/S	:	:	Shield cap 60-120A Max Life	22.91 €
12	NW60444	■		Double pointed spacer	8.96 €
13	07924	:	:	Insulator High Frequency 30-120A	31.49 €
14	51480	:	:	Dysza 30A	2.53 €
	51481	:	:	Contact tip 40A	2.53 €
	51482	:	:	Contact tip 50-60A	2.53 €
15	51484	:	:	Contact tip 60A	2.53 €
	51485	:	:	Contact tip 70A	2.53 €
	51486	:	:	Contact tip 80A	2.53 €
	51487	■	■	Contact tip 90-100A	2.53 €
	51488	:	:	Contact tip 120A	2.53 €
16	60482	:	:	Shield cap body 30-60A	16.02 €
	60482/S	:	:	Shield cap body 30-60A Max Life	25.26 €
17	60483	:	:	Shield cap body 60-120A	16.30 €
	60483/S	:	:	Shield cap body 60-120A Max Life	25.62 €
18	60485	■		Shield cap, hand 30-60A	9.45 €
18a	60487		■	Shield cap, machine 30-60A	8.70 €
19	60486	:	:	Shield cap, hand 60-120A	9.84 €
19a	60488	:	:	Shield cap, machine 60-120A	8.97 €
20	07217	:	:	Mounting block	
21	7-2827	:	:	Pinion assembly	
	09080	:	:	Lead assembly 6m [H] (9/16")	187.04 €
	09085	:	:	Lead assembly 12m [H] (9/16")	349.31 €
	09090	:	:	Lead assembly 6m [M] (9/16")	205.75 €
	09095	:	:	Lead assembly 12m [M] (9/16")	349.31 €

NOTE! There is the difference between UNITO RCH™ hf and UNITO RCH™ no hf versions. (see point 4 / 13).

[H] - parts apply to hand torch,
[M] - parts apply to machine torch

NW® is independent subject and not connected to ABITIG®, AMPHENOL®, ASPA®, BESTER®, BINZEL®, CEA®, CEBORA®, ESAB®, EWM®, FALTIG®, FRO®, FRONIUS®, HARRIS®, HYPERTHERM®, KJELLBERG®, L-TEC®, LINCOLN®, MAGNUM®, OTC®, SAF®, SHERMAN®, TELWIN®, THERMAL DYNAMICS®, TRAFIMET®, TUCHEL®.

Reference numbers and names belonged to above companies were called due to Property Right Law for buyer's convenience and they are related to code and spare part's description.

The products do not constitute an offer within the meaning of the Civil Code.