

PLAZMA – Consumables – THERMAL DYNAMICS® – Maximizer 300 / Merlin 1000/3000/6000/6000GTS®

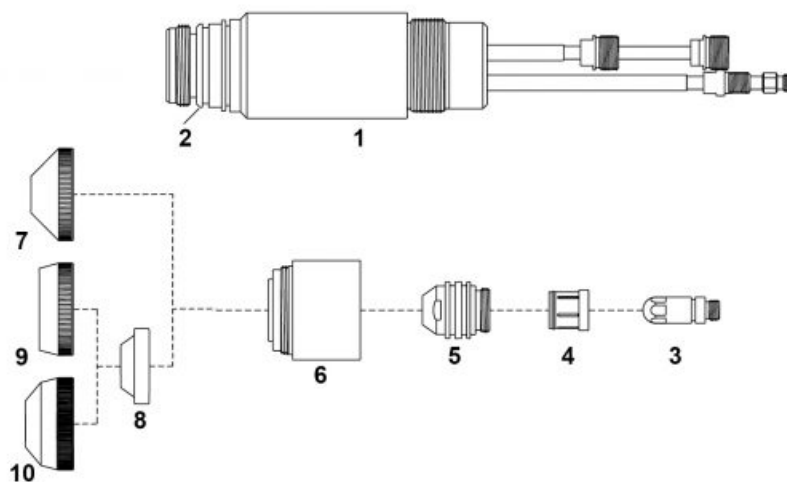

Lp.	Product code	Nr ref.	Product name	Net price
1	08310/TD		Torch head 180°	
2	60341.41		O-ring	
3	52615		Electrode (O2)	
	52614		Electrode	
	52613		Air/O2 electrode 300A	
	52616		Electrode (N2)	
4	60052		Swirl ring 50-250A	
5	51350		Contact tip 50A	
	51351		Contact tip 100A	
	51352		Contact tip 150A	
	51353		Contact tip 200A	
	51354		Contact tip 250A	
6	60396		Shield cap	
	60396S		Shield cap	
	60397		Shield cap body underwater	
7	51990		Shield cap body 50A	
	51991		Shield cap body 100-250A	
	51992		Shield cap body 300A	
8	80023		Ring (non-conductive)	
9	51994		Shield cap body	
10	51997		Shield cap body machine	

NW ® is independent subject and not connected to ABITIG®, AMPHENOL®, ASPA®, BESTER®, BINZEL®, CEA®, CEBORA®, ESAB®, EWM®, FALTIG®, FRO®, FRONIUS®, HARRIS®, HYPER THERM®, KJELLBERG®, L-TEC®, LINCOLN®, MAGNUM®, OTC®, SAF®, SHERMAN®, TELWIN®, THERMAL DYNAMICS®, TRAFIMET®, TUCHEL®.

Reference numbers and names belonged to above companies were called due to Property Right Law for buyer's convenience and they are related to code and spare part's description.

The products do not constitute an offer within the meaning of the Civil Code.