

## PLAZMA – Consumables – HYPERTHERM® – POWERMAX 45® H45® – ALTERNATIVE

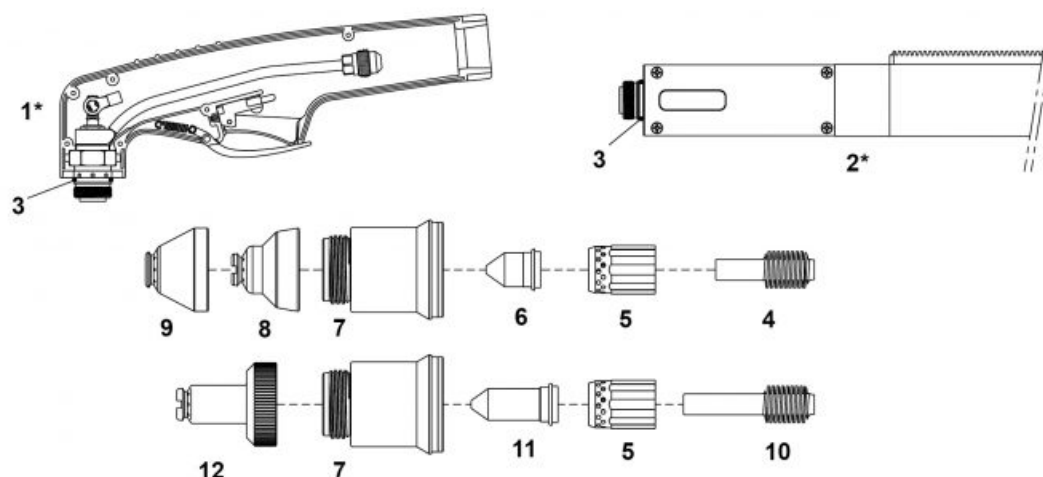

Lp.	Product code	Nr ref.	Product name	Net price
1*	NW03600/KIT		Hand torch head with handgrip	
2*	03610/KIT		Hand torch head	
3	NW07300.60		O-ring	
4	52574		Electrode	
5	60041		Swirl ring	
6	51206		Nozzle 45A	
7	60305T		Retaining cap	
8	51923		Shiled cap, hand	
9	51924		Shield cap, machine	
10	52574L		Extended electrode	
11	51206L		Extended tip 45A	
12	51923L		Hand shield	

NOTE! \*Torch connection from the cables side like in 228346, 228320

NW ® is independent subject and not connected to ABITIG®, AMPHENOL®, ASPA®, BESTER®, BINZEL®, CEA®, CEBORA®, ESAB®, EWM®, FALTIG®, FRO®, FRONIUS®, HARRIS®, HYPERTHERM®, KJELLBERG®, L-TEC®, LINCOLN®, MAGNUM®, OTC®, SAF®, SHERMAN®, TELWIN®, THERMAL DYNAMICS®, TRAFIMET®, TUCHEL®.

Reference numbers and names belonged to above companies were called due to Property Right Law for buyer's convenience and they are related to code and spare part's description.

The products do not constitute an offer within the meaning of the Civil Code.