

PLAZMA – Consumables – HYPERTHERM® – MAX40® / PAC140® / HT40®

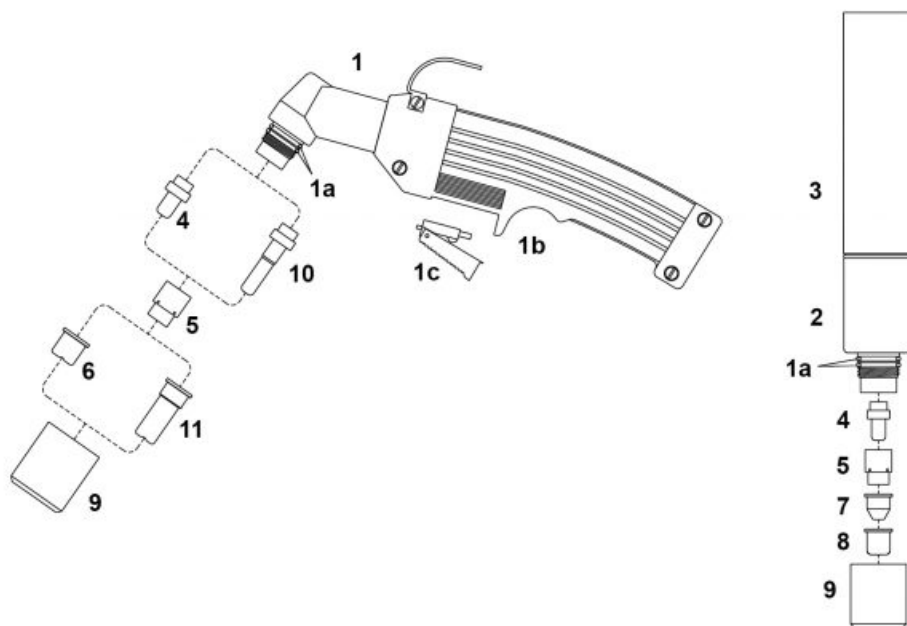

| Lp. | Product code | Nr ref. | Product name | Net price |
|-----|--------------|---------|----------------------------|-----------|
| 1 | 07300/KIT | | Hand torch body | |
| 1a | NW07300.60 | | O-ring | |
| 1b | 07301 | | Handgrip with microswitch | |
| 1c | NW07301.20 | | Microswitch | |
| 2 | 07310 | | Machine torch body | |
| 3 | 07315 | | Machine handle | |
| 4 | NW52512L | | Electrode | |
| 5 | NW60001 | | Swirl ring | |
| 6 | NW51100 | | Tip fi 1.0 | |
| 7 | NW51098 | | Conical tip fi 1.0 | |
| 8 | 51099 | | Flat tip fi 1.0 | |
| 9 | 60301 | | Retaining cap | |
| 10 | NW52513L | | Extended electrode | |
| 11 | NW51102 | | Extended tip fi 1.0 | |
| | 07380 | | Cable, 7.5 – hand torch | |
| | 07385 | | Cable, 15m – hand torch | |
| | 07390 | | Cable, 7.5 – machine torch | |
| | 07395 | | Cable, 15m – machine torch | |

NW ® is independent subject and not connected to ABITIG®, AMPHENOL®, ASPA®, BESTER®, BINZEL®, CEA®, CEBORA®, ESAB®, EWM®, FALTIG®, FRO®, FRONIUS®, HARRIS®, HYPERTHERM®, KJELLBERG®, L-TEC®, LINCOLN®, MAGNUM®, OTC®, SAF®, SHERMAN®, TELWIN®, THERMAL DYNAMICS®, TRAFIMET®, TUCHEL®.

Reference numbers and names belonged to above companies were called due to Property Right Law for buyer's convenience and they are related to code and spare part's description.

The products do not constitute an offer within the meaning of the Civil Code.