

PLASMA - Consumables - HYPERTHERM® - POWERMAX 65® H65/M65® / POWERMAX 85® H85/M85® / POWERMAX 105® H105/M105® / POWERMAX 1000/1250/1650® HRT® MRT® - ALTERNATIVE

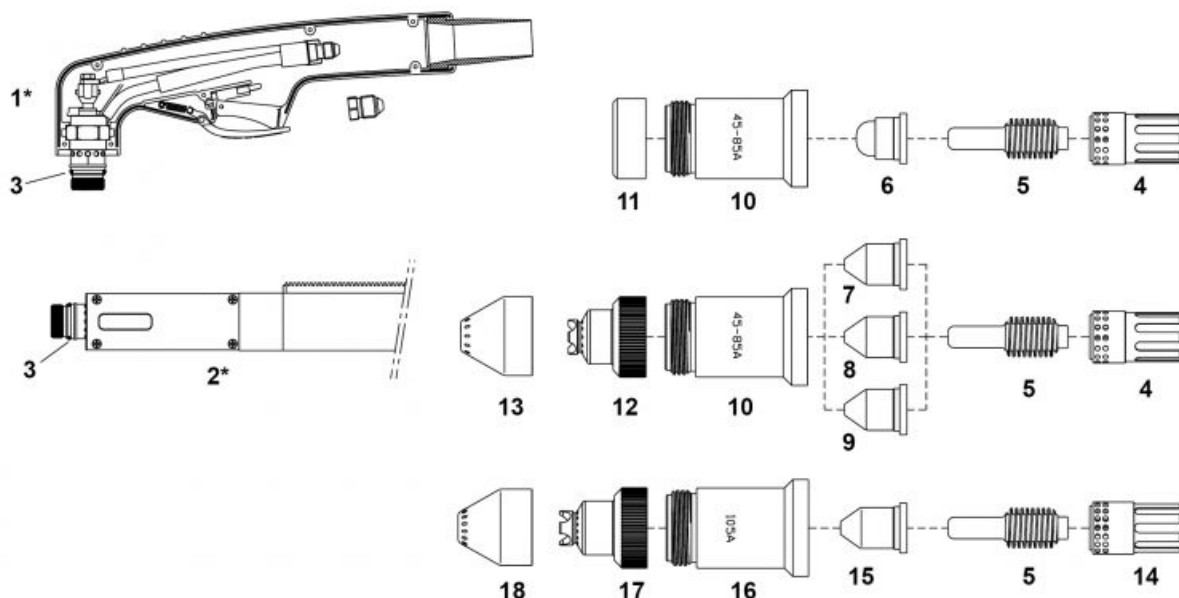

| Lp. | Product code | Nr ref. | Product name | Net price |
|-----|--------------|---------|--------------------------------|-----------|
| 1 | NW03700KIT | | Hand torch head with handgrip* | |
| 2* | NW03710KIT | | Machine torch head* | |
| 3 | NW3700.60 | | O-ring | |
| 4 | NW60042 | | Swirl ring 45-85A | |
| 5 | NW52677 | | Electrode 45-125A | |
| 6 | NW51415 | | Tip 45A Precision Cut | |
| 7 | NW51416 | | Nozzle 45A | |
| 8 | NW51417 | | Nozzle 65A | |
| 9 | NW51418 | | Nozzle 85A | |
| 10 | NW60309TA | | Retaining cap 45-85A | |
| 11 | NW51928 | | Deflector 45A | |
| 12 | NW51921 | | Shield cap 45-85A | |
| 13 | NW51922 | | Shield cap, machine 45-85A | |
| 14 | NW60040 | | Swirl ring Max Life 100-125A | |
| 15 | NW51419 | | Nozzle 105A | |
| 16 | NW60309TB | | Retainig cap 105A | |
| 17 | NW51926 | | Hand shield 100-125A | |
| 18 | NW51927 | | Machine shield 100-125A | |

NOTE! *Torch connection from the cables side like in OEM 228958, 228716

NW ® is independent subject and not connected to ABITIG®, AMPHENOL®, ASPA®, BESTER®, BINZEL®, CEA®, CEBORA®, ESAB®, EWM®, FALTIG®, FRO®, FRONIUS®, HARRIS®, HYPERTHERM®, KJELLBERG®, L-TEC®, LINCOLN®, MAGNUM®, OTC®, SAF®, SHERMAN®, TELWIN®, THERMAL DYNAMICS®, TRAFIMET®, TUCHEL®.

Reference numbers and names belonged to above companies were called due to Property Right Law for buyer's convenience and they are related to code and spare part's description.

The products do not constitute an offer within the meaning of the Civil Code.