

MIG - Consumables - NW®/SPARTUS® - typ 150

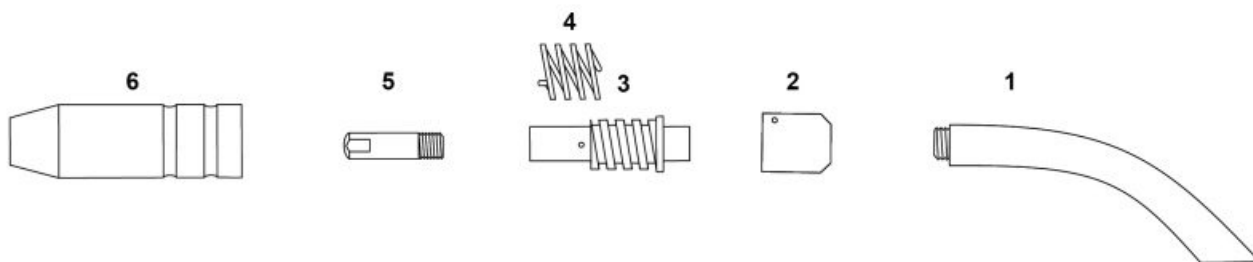

Lp.	Product code	Nr ref.	Product name	Type	Wire diameter [mm]	Net price
1	15-00-001		Swan neck with contact tip holder 150			3.06 €
	15F-00-001		Flexible swan neck with contact tip holder 150F			45.56 €
	SP15R-00-011		Rotary swan neck 150R with contact tip holder			10.01 €
	SP15R-00-001		Rotary swan neck 150R with contact tip holder [old version]			10.01 €
2	15-32-006		Insulator ring (torch 150)			0.19 €
3	15-30-006		Contact tip holder with spring (torch 150)			0.41 €
4	15-31-006		Spring (torch 150)			0.05 €
5	15-20-006		Contact tip M6x25mm E-Cu 0,6mm	E-Cu	0.6	0.14 €
	15-20-008		Contact tip M6x25mm E-Cu 0,8mm	E-Cu	0.8	0.14 €
	15-20-010		Contact tip M6x25mm E-Cu 1,0mm	E-Cu	1.0	0.14 €
	15-20-012		Contact tip M6x25mm E-Cu 1,2mm	E-Cu	1.2	0.14 €
	15-20-014		Contact tip M6x25mm E-Cu 1,4mm	E-Cu	1.4	0.14 €
	15-20-016		Contact tip M6x25mm E-Cu 1,6mm	E-Cu	1.6	0.14 €
	15-21-008		Contact tip M6x25mm E-Cu for Al 0,8mm	E-Cu to Al	0.8	0.14 €
	15-21-010		Contact tip M6x25mm E-Cu for Al 1,0mm	E-Cu to Al	1.0	0.14 €
	15-21-012		Contact tip M6x25mm E-Cu for Al 1,2mm	E-Cu to Al	1.2	0.14 €
	15-22-008		Contact tip M6x25mm CuCrZr 0,8mm	CuCrZr	0.8	0.24 €
	15-22-010		Contact tip M6x25mm CuCrZr 1,0mm	CuCrZr	1.0	0.24 €
	15-22-012		Contact tip M6x25mm CuCrZr 1,2mm	CuCrZr	1.2	0.24 €
	15-22-014		Contact tip M6x25mm CuCrZr 1,4mm	CuCrZr	1.4	0.24 €
6	15-50-095		Gas nozzle fi9,5			1.23 €
	15-50-120		Gas nozzle fi12			0.62 €
	15-50-160		Gas nozzle fi16			1.23 €

NW ® is independent subject and not connected to ABITIG®, AMPHENOL®, ASPA®, BESTER®, BINZEL®, CEA®, CEBORA®, ESAB®, EWM®, FALTIG®, FRO®, FRONIUS®, HARRIS®, HYPERTHERM®, KJELLBERG®, L-TEC®, LINCOLN®, MAGNUM®, OTC®, SAF®, SHERMAN®, TELWIN®, THERMAL DYNAMICS®, TRAFIMET®, TUCHEL®.

Reference numbers and names belonged to above companies were called due to Property Right Law for buyer's convenience and they are related to code and spare part's description.

The products do not constitute an offer within the meaning of the Civil Code.